

- US** INSTALLATION INSTRUCTION - ILLUMINATED DOOR SILL
- E** INSTRUCCIONES DE INSTALACION - SEUIL DE PORTE ILLUMINÉ
- F** INSTRUCTIONS D'INSTALLATION - ESTRIBO DE PUERTA ILLUMINADO

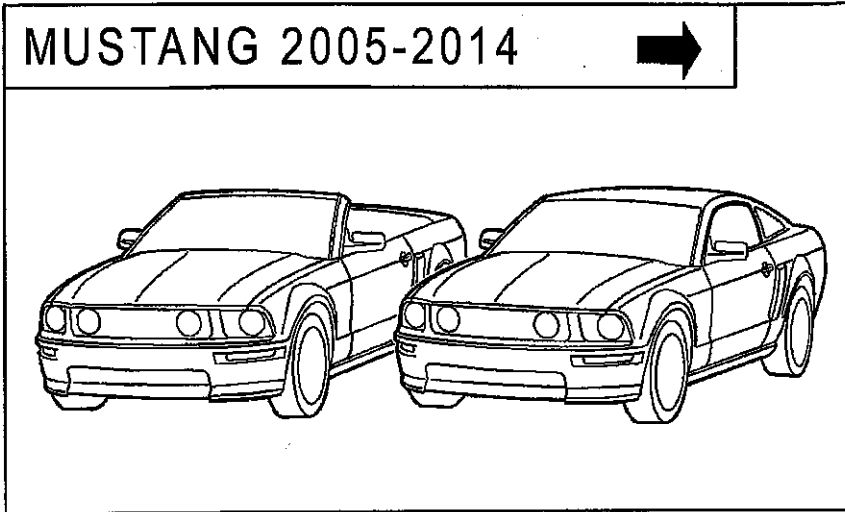

www.classicdesignconcepts.com
 Questions: 866-624-7997

Subject to alteration without notice
 Reservadas modificaciones técnicas
 Sous réserve de modifications techniques



- PERSONAL INJURY
LESIONES PERSONALES
RISQUE DE BLESSURE
- VEHICLE DAMAGE
DANO DE VEHICULO
DOMMAGE AU VÉHICULE
- INCORRECT
INCORRECTO
INCORRECT
- CORRECT
CORRECTO
CORRECT
- SEE MANUAL
VER MANUAL
VOIR LE MANUEL

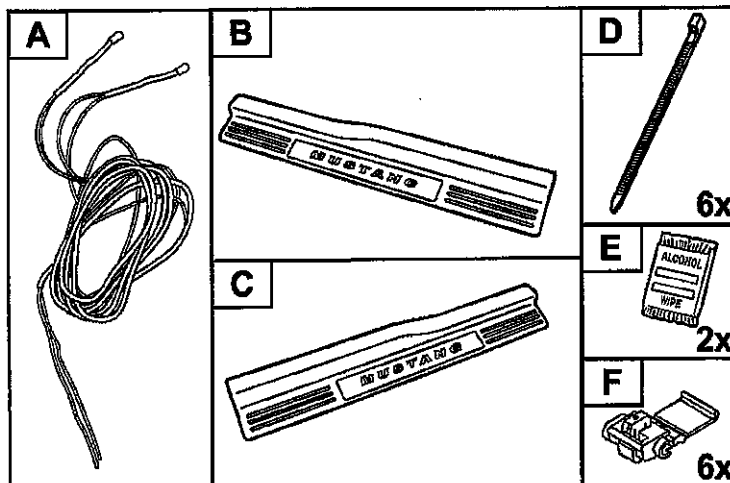

For 2005-2014 vehicles WITHOUT ambient lighting.

- Kit includes:
- A. 1-Wiring harness
 - B. 1-RH Scuff plate
 - C. 1-LH Scuff plate
 - D. 6-tie straps
 - E. 2-alcohol wipes
 - F. 6-quick connects

For 2005-2014 vehicles WITH ambient lighting.

- Kit includes:
- B. 1-RH Scuff plate
 - C. 1-LH Scuff plate
 - E. 2-alcohol wipes

For installation follow steps:

- Step 9: Remove RH old scuff, press locking tab to disconnect wire connectors
- Step 13: Connect new scuff in existing connector
- Step 15: Peel tape liners and install new scuff
- Repeat on LH side

TOOLS REQUIRED
 HERRAMIENTAS NECESARIAS
 OUTILS NÉCESSAIRES

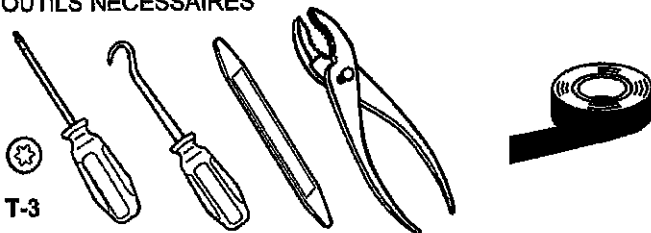

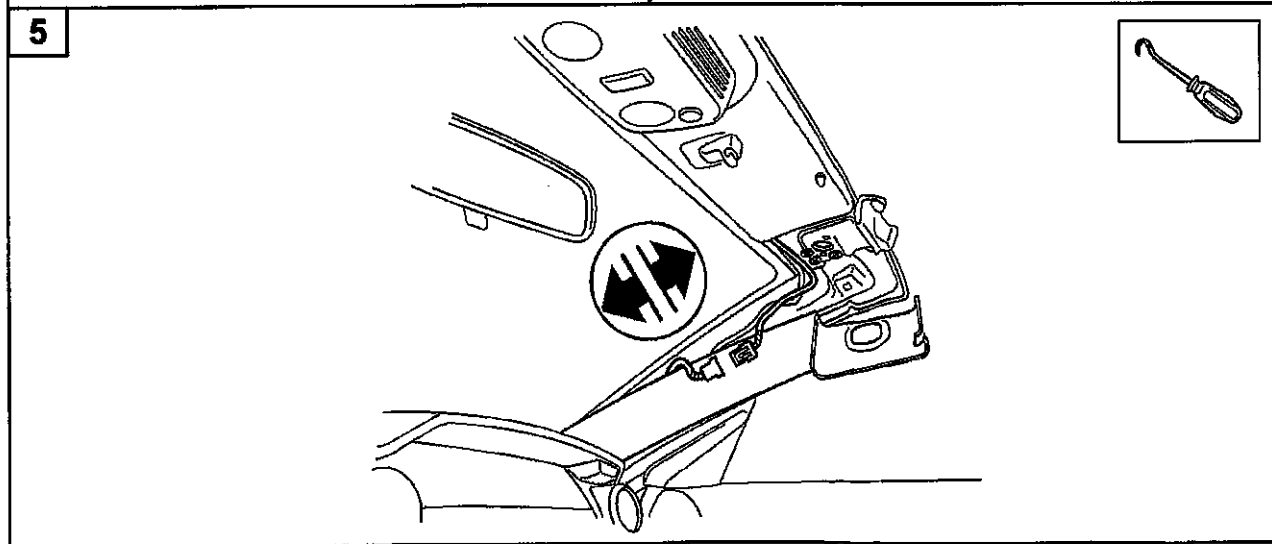
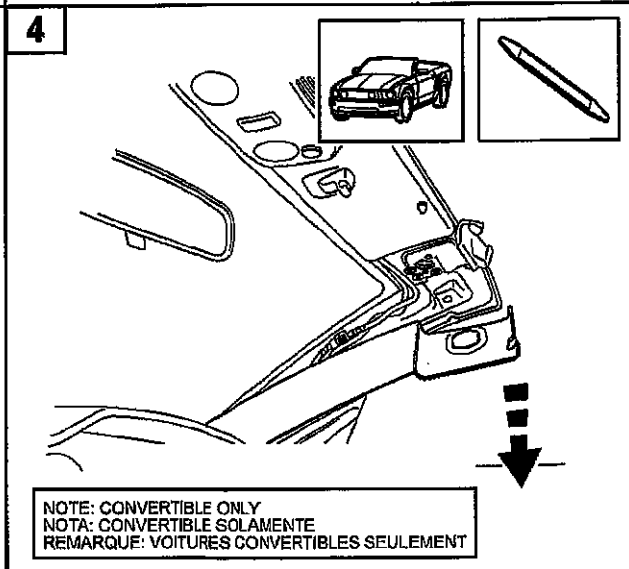
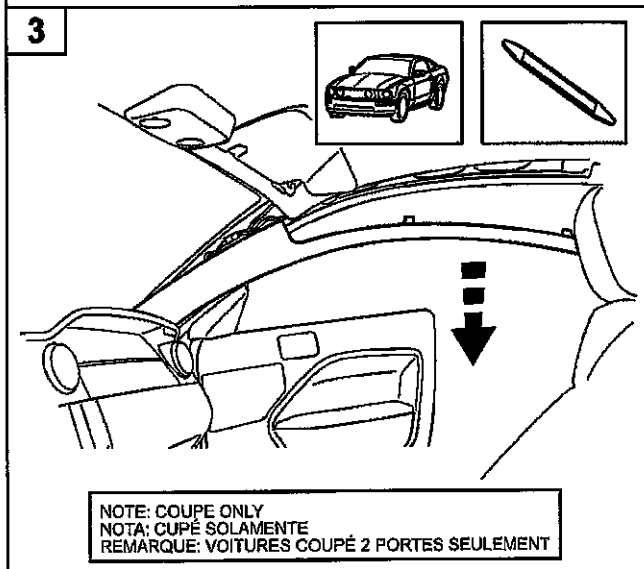
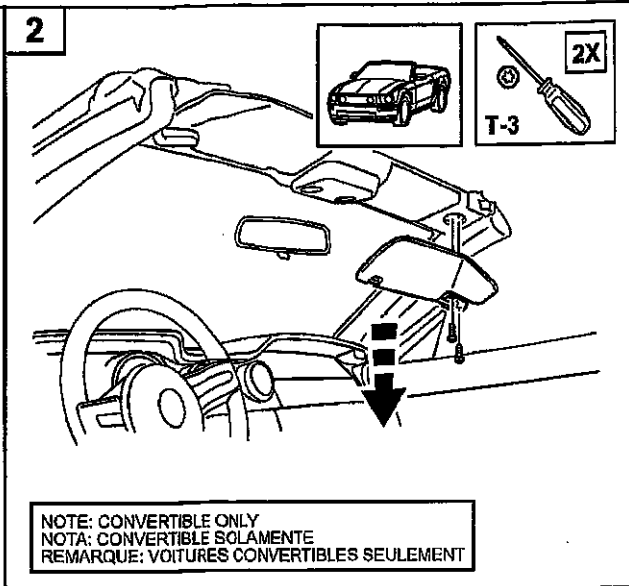
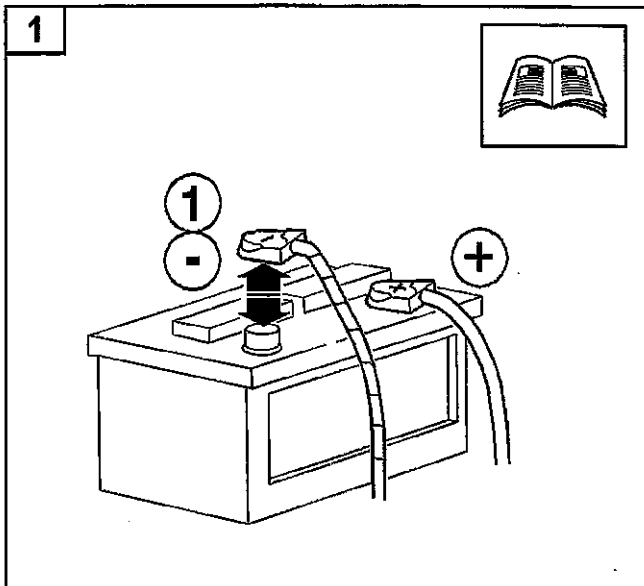

6

GROUND WIRE COLOR:
FOR 2005-2009 LIGHT GREEN/YELLOW
FOR 2010-2014: BLACK/YELLOW

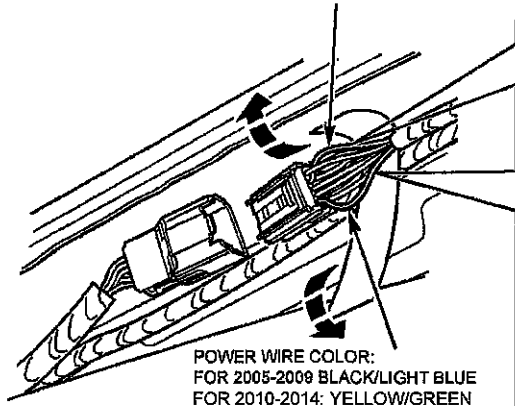

POWER WIRE COLOR:
FOR 2005-2009 BLACK/LIGHT BLUE
FOR 2010-2014: YELLOW/GREEN

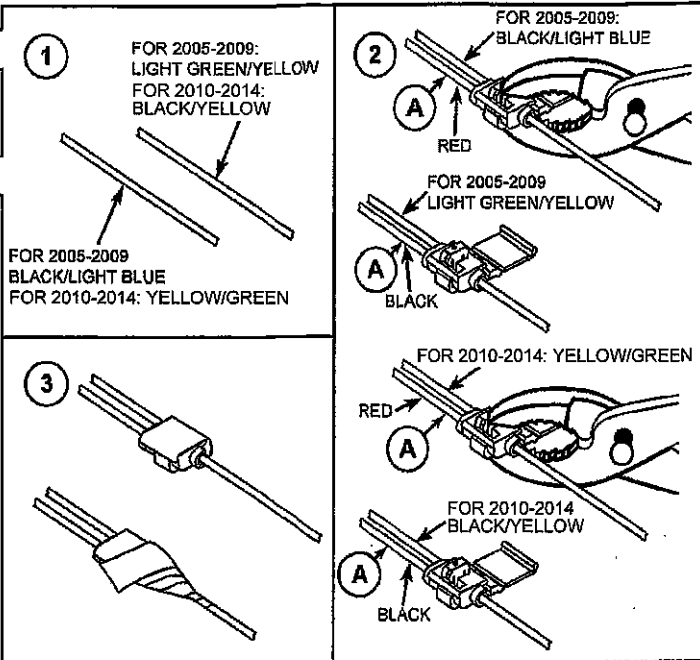
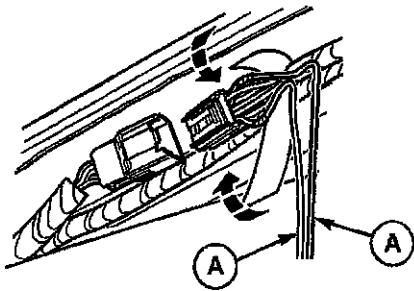

7

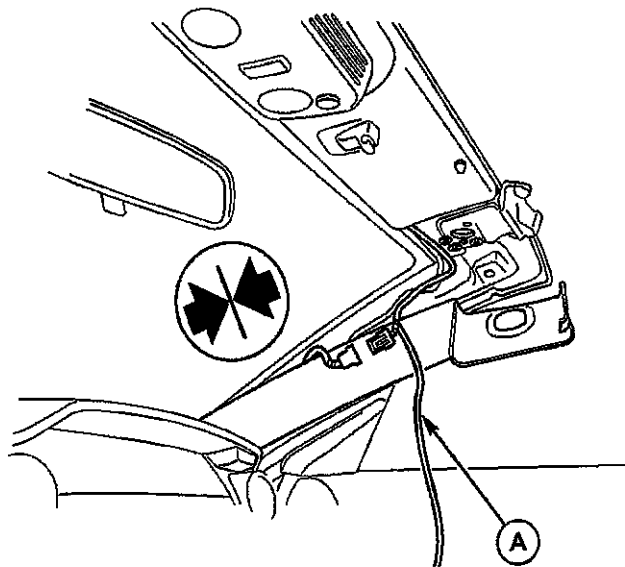

8

